

Classroom Location: Cascade College Campus

9101 E Burnside St.
Portland, OR 97216

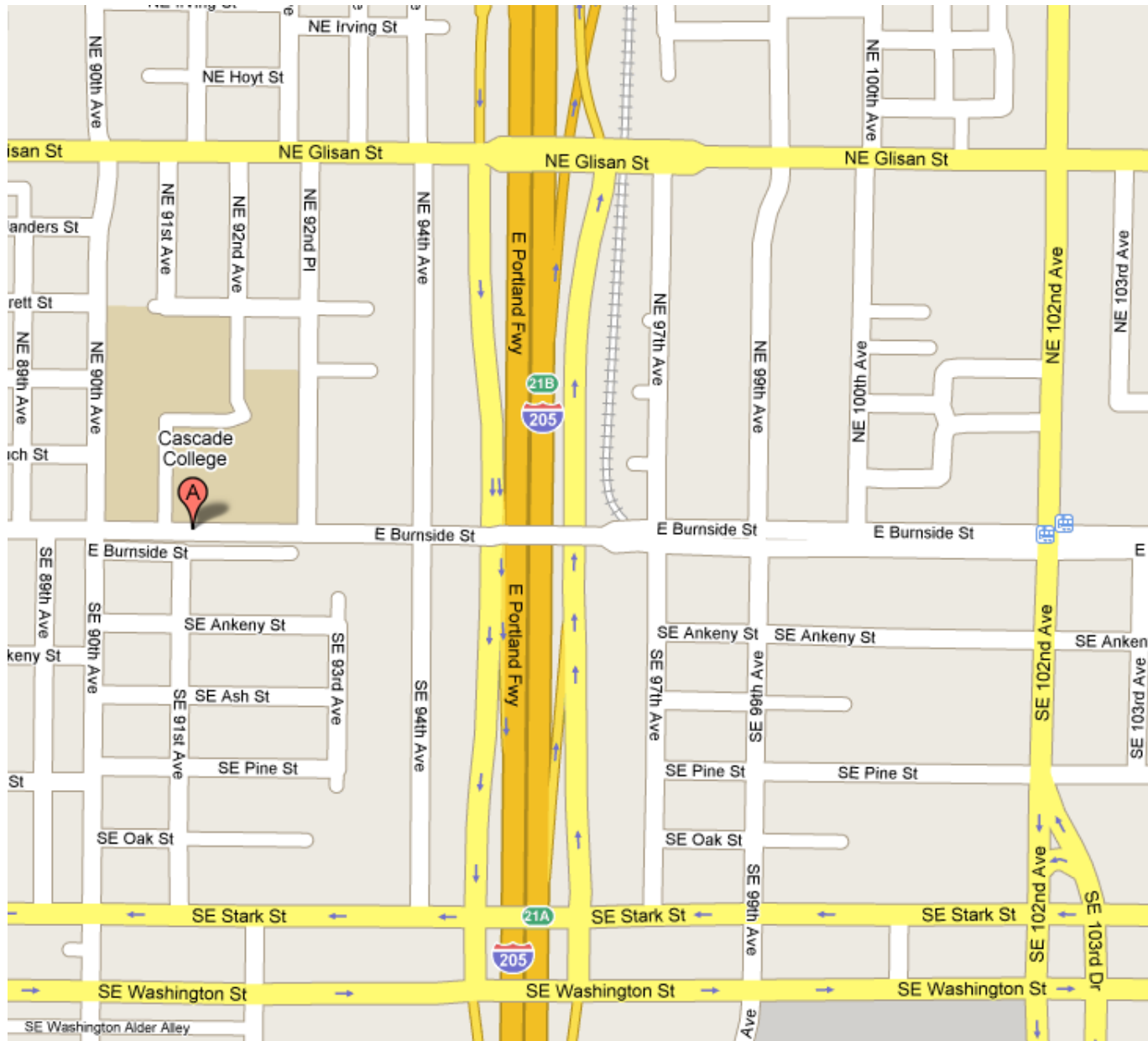

I-84 Westbound

(from Troutdale)

Take I-84 W/US-30 W to exit 9 (on a left fork). Take exit 9 to merge onto I-205 S/Veterans Mem Hwy toward Salem. Now, follow directions for I-205 Southbound.

I-205 Southbound

(from the Airport/PDX)

Take I-205 South to exit 21. Turn right onto Glisan (heading west), turn left onto 90th (only about 5 blocks - just after Eastside Church of Christ building), and turn left onto Burnside. The entrance to Cascade College is immediately on your left.

I-205 Northbound

(from Oregon City)

Take I-205 North to exit 21. Turn left onto Glisan (heading west), turn left onto 90th (only about 5 blocks - just after Eastside Church of Christ building), and turn left onto Burnside. The entrance to Cascade College is immediately on your left.

HWY-26 Eastbound

(from Hillsboro/Beaverton)

Head east on Highway 26 (coming from Seaside). After you pass the Highway 217 interchange (don't take it), get in the right lane and follow the signs to "The Dalles I-84" - this will take you over the Marquam Bridge and onto I-84. After about 7 miles, take I-205 south (toward Salem) *and immediately keep right* and take the Glisan exit. Turn right onto Glisan (heading west), turn left onto 90th (only about 5 blocks - just after Eastside Church of Christ building), and turn left onto Burnside. The entrance to Cascade College is immediately on your left.

← To Portland

To Gresham →

Sanders Hall

First Floor

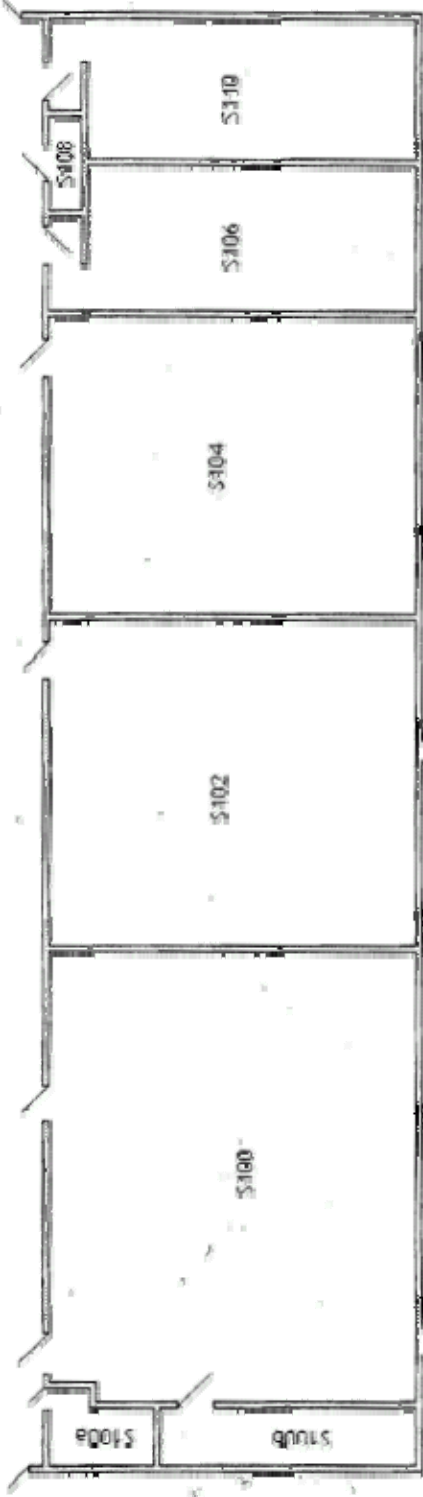
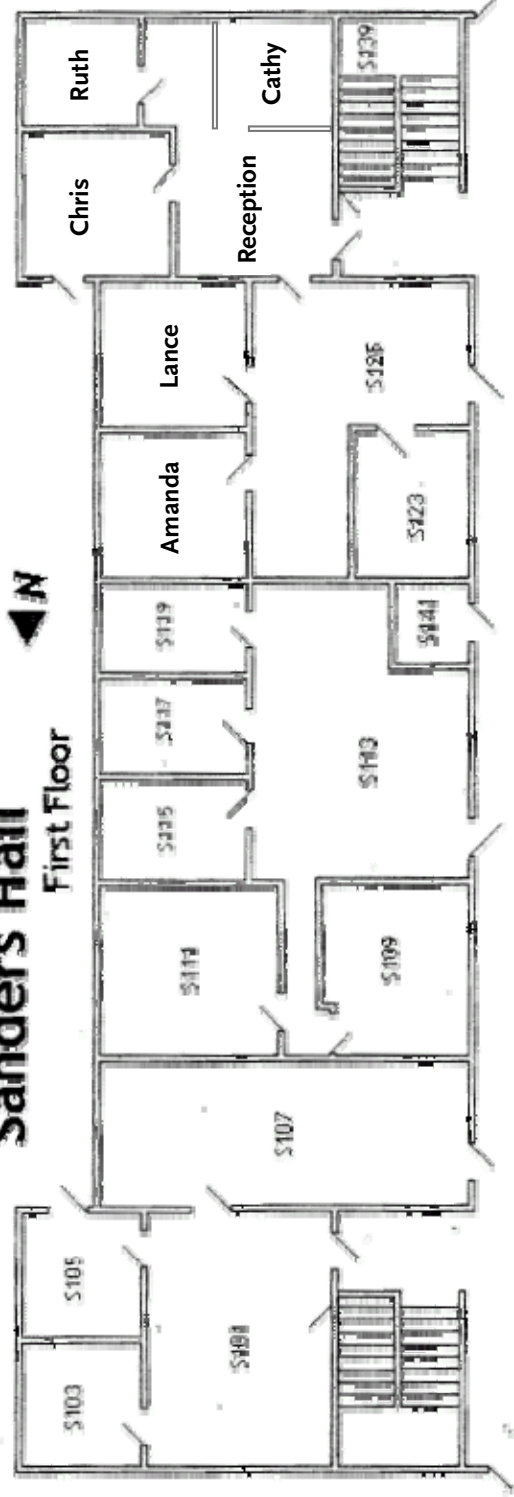

Sanders Hall

Second Floor

